

Toggle Switch



RoHS

Rating: 3A 125VAC ; 1.5A 250VAC Contact
Resistance: 20m Ω max
Insulation Resistance: 500VDC 1000M Ω min

Dielectric Strength: 1000VAC, 1 Minute
Operating Temperature: -25°C ~ +85°C
Electrical Life: ≥ 10,000 Cycles

TOPTek[®]
HARDWARE ELECTRONIC MANUFACTURER

www.toptek-co.com

BTS-101

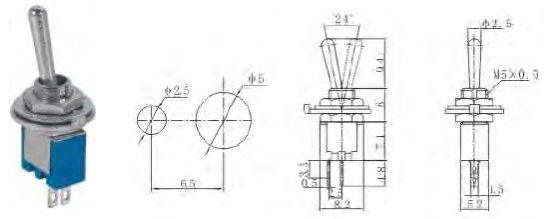

**BTS-101 ON-OFF
SPST 2P**

BTS-102

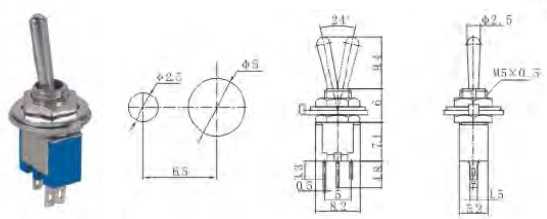

**BTS-102 ON-ON
SPDT 3P**

BTS-202

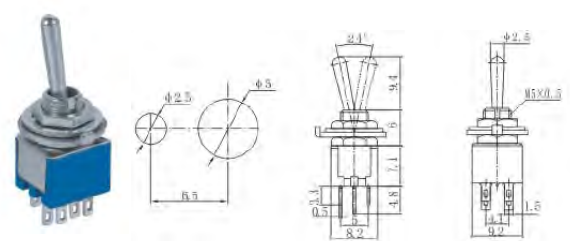

**BTS-202 ON-ON
DPDT 6P**

BTS-102-A2

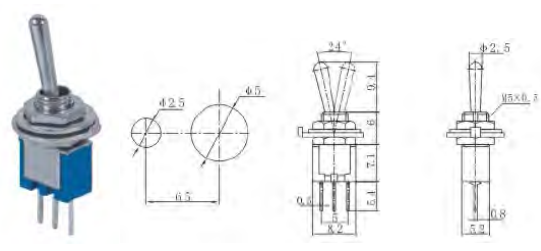

**BTS-102-A2 ON-ON
SPDT 3P**

BTS-202-A2

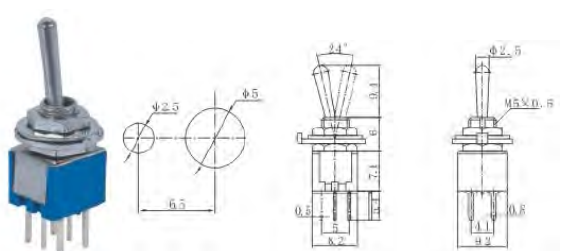

**BTS-202-A2 ON-ON
DPDT 6P**

BTS-103-2A1

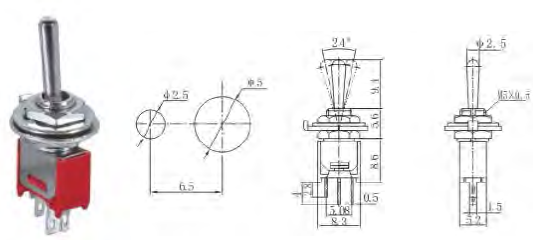

**BTS-103-2A1 ON-OFF-ON
SPDT 3P**

BTS-203-2A2

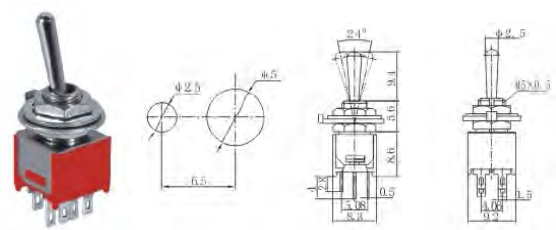

**BTS-203-2A2 ON-OFF-ON
DPDT 6P**

BTS-102-103-2C3

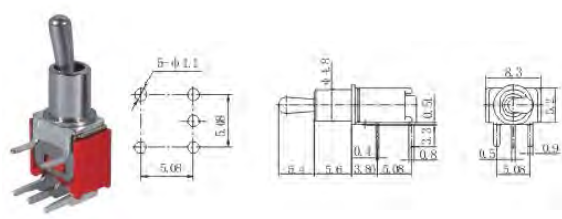

**BTS-102-2C3 ON-ON
BTS-103-2C3 ON-OFF-ON
SPDT 3P**

14
*
33

